

**PHILIPS**

**RESPIRONICS**

InnoSpire Essence

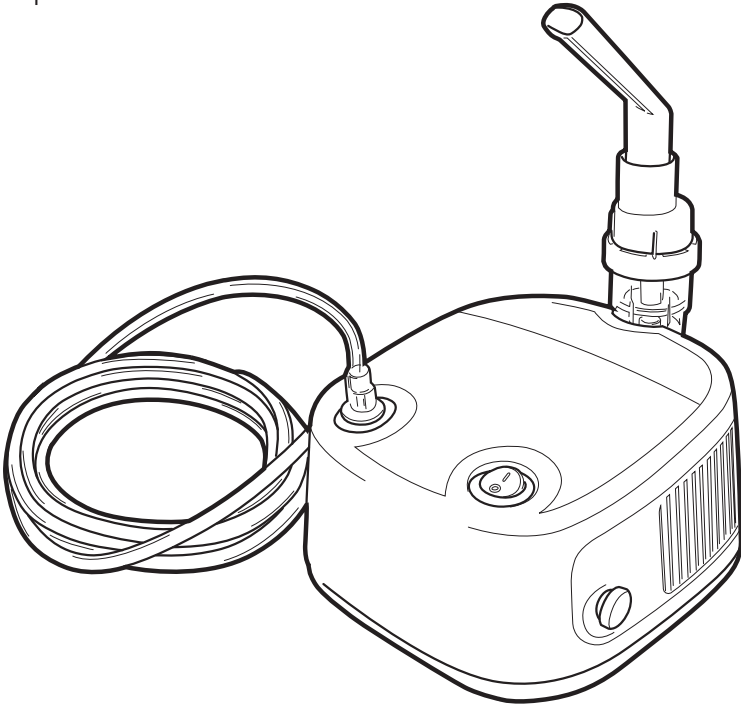

# InnoSpire Essence

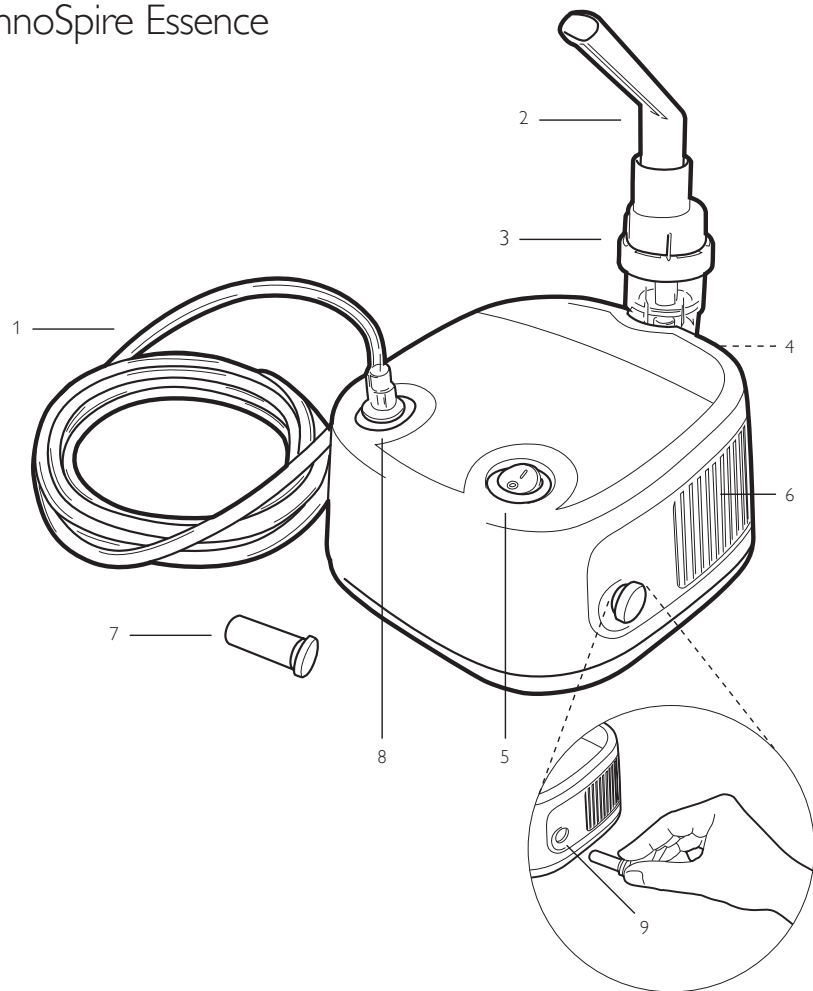

1. Nebulizer tubing
2. Nebulizer mouthpiece
3. Nebulizer handset
4. Nebulizer holder
5. On/Off power switch
6. Compressor air openings
7. Air filter
8. Compressor air outlet
9. Air inlet for filter

## Instructions for use

### InnoSpire Essence

**Important:** Read these instructions carefully before using this device. If you have any questions or problems with the product, please contact your healthcare provider or Philips Respironics Customer Service at +00 1 724 387 4000.

## General information

**Intended use:** This product is intended to provide a source of compressed air for medical purposes. It is to be used with a pneumatic (jet) nebulizer to produce aerosol particles of medication for respiratory therapy for both children and adults.



### WARNINGS

- 1 **Use the device for its intended purpose as described in this instruction manual as a compressor nebulizer system for aerosol therapy. Follow your doctor's instructions.**  
Any other use constitutes improper use and may be dangerous. The manufacturer cannot be held liable for any damage caused by improper, incorrect or unreasonable use or if the unit is connected to electrical installations not complying with safety regulations.
  - It is recommended to have a backup device (e.g. MDI or battery operated compressor) for respiratory delivery in case a situation arises when your nebulizer cannot be used (e.g. during a power outage or if your compressor becomes inoperable for any reason).
  - If the device has been outside of the operating conditions, allow to come back to normal operating specifications before use.
  - Any liquid spilled on or inside the unit should be allowed to dry before operating.
- 2 Keep this manual for future reference.
- 3 Use the product in a clean environment; one that is free from dirt, dust, pet hair; etc.
- 4 Device should not be used around flammable substances, or in the presence of a flammable anesthetic mixture with air, oxygen or nitrous oxide.
- 5 No modification of this equipment is allowed.
- 6 It is normal for the device to be warm to the touch when in use.
- 7 Do not stack the compressor with other equipment.

- 8 **Electromagnetic information:** Portable and RF communication devices such as cellular phones, pagers, etc. can interrupt operation of electrical medical equipment. For this reason, your compressor must be placed far enough away from these devices to prevent interference. This device meets IEC60601-1-2 standard for electromagnetic compatibility (EMC). EMC data sheets are available from Philips Respironics customer service at +00 1 724 387 4000.
- 9 In case of failure and/or malfunction, read the "Troubleshooting" section. Do not open the compressor housing as this is not a serviceable product.
- 10 The proper function of the device can be compromised if original replacement parts (e.g., filters) are not used.
- 11 Risk of electric shock do not remove back.
- 12  Risk of electric shock.
- 13 This device is for intermittent use 30 min on/30 min off. Failure to operate appropriately may lead to device damage.
- 14 Do not use the device without the filter.
- 15 When using any electrical appliance, certain important safety measures must always be followed, including the following:
  - Use only manufactured-supplied original accessories and components;
  - Never submerge the unit in water as the device is not protected against water penetration;
  - Never touch the unit when your hands are wet or moist;
  - Do not leave the unit outdoors;
  - Place on a stable and horizontal surface when operating;
  - Make sure the air vent openings are not obstructed;
  - Do not allow unsupervised children or infirm individuals to use the unit;
  - Do not turn off the unit by simply pulling out the plug from the electrical outlet;
  - Do not use in a ventilator circuit;
  - Do not use if the device has cracks or is damaged.
- 16 Make sure that the electrical rating shown on the rating label on the bottom of the unit corresponds to your main voltage and frequency before plugging in the device.
- 17 Do not use any adapter, simple or multiple, and/or extension cord.
- 18 Do not leave the unit plugged in when not in use. Unplug the device from the electrical outlet when not in operation.
- 19 Follow the manufacturer's instructions for installing the device. The manufacturer cannot be held responsible for any damage caused by incorrect installation.
- 20 The power supply cord cannot be replaced by the user. In case the power supply cord becomes damaged, contact Philips Respironics customer service for replacement (there is no service option).

- 21 Before performing any cleaning operation or filter replacement, disconnect the device from the main supply by unplugging it.
- 22 Some parts are small enough to be swallowed by children. Do not let unattended children have access to the unit.
- 23 If you no longer use the device, dispose of according to the local regulations in force.
- 24 Remember to:
  - Use this device only with medications prescribed by your doctor;
  - Use the accessories recommended by your doctor.

## Instructions for use

### Remove the compressor from carrying case if supplied before use.

- 1 After unpacking the device, check the compressor and accessories for visible damage or defects such as cracks in the plastic housing which could expose electrical components. Contact Philips Respironics customer service or your product distributor to report any damaged product.
- 2 When taking a treatment, sit upright and relaxed.
- 3 Plug the compressor into the electrical outlet.
- 4 Refer to the nebulizer and accessory instructions for use before treatment.
- 5 To start the treatment, switch the device ON by pressing the ON / OFF switch onto the "I" position.
- 6 When the treatment has been completed, switch the unit OFF by setting the switch position to "O" and disconnect the plug from the electrical outlet.

 **This device is for intermittent use 30 min on/30 min off. Failure to operate appropriately may lead to device damage.**

## Cleaning and maintenance

 **During cleaning, make sure the power cord is not plugged in the electrical outlet.**

### Cleaning of the compressor, nebulizer and accessories

Wash the nebulizer and accessories according to its instructions.

Use a clean damp cloth to clean the outside of the unit.

### Replacement of the nebulizer

The nebulizer and other accessories should be replaced according to its instructions.

### Replacement of the filter

The filter is to be replaced when it appears discolored or wet.

### Troubleshooting

The device does not turn on

- Make sure the plug is firmly fitted to the electrical outlet.

In the event of malfunction (insufficient pressure and flow) turn the unit off for 10 seconds and turn back on.

After each cleaning, check that the unit is working properly by verifying that air still comes out of the nozzle when the unit is turned to the "ON" position.

Unauthorized repair voids warranty.

**If the device does not work properly after attempting these troubleshooting steps, contact your authorized product distributor or Philips Respironics Customer Service at +00 1 724 387 4000.**

### Maintenance and repairs

**Never open the device.** There are no serviceable parts within the unit. The compressor requires no lubrication or maintenance.

### Technical specifications

Electricity supply	230 V/50 Hz, 1 Amp
Thermal overload protector	Thermal fuse; functioning temperature 150 C°
Compressor max. pressure	317 kPa (46 psi)
Average flow rate	6 LPM @ 10 psig
Max flow rate	8.0 LPM
Weight	1.5 kg
Size	165 x 165 x 108 mm
Noise level	58 ±3dBA

### Technical specifications

Electricity supply	220 V/60 Hz, 1.2 Amp
Thermal overload protector	Thermal fuse; functioning temperature 150 C°
Compressor max. pressure	296 kPa (43 psi)
Average flow rate	7 LPM @ 10 psig
Max flow rate	9.3 LPM
Weight	1.5 kg
Size	165 x 165 x 108 mm
Noise level	58 ±3dBA

Class II device, Type B device (device with specific protection against electrical hazards).

DOUBLE INSULATED

#### Reference to standards

Electric safety standards IEC 60601-1

Electromagnetic compatibility according to IEC 60601-1-2



#### Ambient conditions

##### Storage conditions

Temperature MIN -25 °C – MAX 70 °C (-13 °F – 158 °F)

Humidity MIN 10% RH – MAX 95% RH

##### Operating conditions

Temperature MIN 5 °C – MAX 40 °C (41 °F –104 °F)

Humidity MIN 10% RH – MAX 95% RH

Operating atmospheric pressure Performance may vary depending on altitude above sea level, barometric pressure and temperature

#### Symbol glossary

 ON (power)

 OFF (power)

 Serial number

 Follow instructions for use

 Separate collection

 ATTENTION

 Alternating current

 European Representative

 Manufactured by

 Class II, double insulated

 Type B applied parts

 Indoor use only

 Temperature limitation

#### Warranty

Respironics New Jersey, Inc. warrants the compressor to be free from defects in materials and workmanship under normal use and operation for a period of 3 years from date of purchase from Respironics New Jersey, Inc. The warranty is limited to repair or replacement, at Respironics New Jersey, Inc.'s sole option, of any such component or equipment claimed to be defective when claim is shown to be bona fide by evaluation by Respironics New Jersey, Inc. This warranty does not extend to any components or equipment subjected to misuse, improper operation, accidental damage, or unauthorized repairs, and is not extended to charges of, or for, labor repairs. All items returned must be properly packaged and shipped, prepaid, by the product distributor servicing the unit. Respironics New Jersey, Inc. shall not be liable to purchaser or others for loss of use of equipment or for indirect, or incidental or consequential damages that might arise.

InnoSpire Essence is a trademark of Koninklijke Philips Electronics N.V. and its affiliates, all rights reserved.

© 2012 Koninklijke Philips Electronics N.V. All rights are reserved.



Respironics New Jersey, Inc.  
5 Wood Hollow Road  
Parsippany, NJ 07054 USA

Made in China

Respironics Deutschland GmbH  
Gewerbestr. 17  
82211 Herrsching, Germany

[www.philips.com/respironics](http://www.philips.com/respironics)