

Pacifica

Compressor Nebulizer

Item # 18060
Instruction Manual

Instruction Manual
Includes Disposable Nebulizer Kit



SAVE THESE INSTRUCTIONS.
READ ALL INSTRUCTIONS BEFORE USE.

CAUTION - U.S. Federal Law restricts this device to sale by or on the order of a physician.

This product has been tested and successfully approved with the following standards:
EN 60601-1
EN 60601-1-2



Contents

IMPORTANT SAFEGUARDS	1
Introduction.....	2
Product Description.....	3
Operation.....	4
Cleaning.....	5
Storage.....	6
Maintenance.....	7
Troubleshooting.....	8
Specifications.....	9

1. IMPORTANT SAFEGUARDS

DANGER - To reduce the risk of electrocution:

1. Always unplug this product immediately after using.
2. Do not use while bathing, showering, dish washing, or close to water sources of any kind.
3. Do not place or store product where it can fall or be pulled into a tub or sink.
4. Do not place in or drop into water or other liquid.
5. Do not reach for a product that has fallen into water. Unplug immediately.

WARNING - To reduce the risk of burns, electrocution, fire or injury to persons:

1. This product should never be left unattended when plugged in.
2. Close supervision is necessary when this product is used by, on or near children or invalids.
3. Use this product only for its intended use as described in this manual. Use this product only under doctor's direction. Do not use attachments not recommended by the manufacturer.
4. Never operate this product if a) it has a damaged cord or plug, b) it is not working properly, c) it has been dropped or damaged, d) it has been dropped into water. Return the product to a specified service center for examination and repair.
5. Keep the cord away from heated surfaces.
6. Never block the air openings of this product or allow objects to fall or be inserted into the air vent openings or place it on a soft surface such as bed or couch, where the air openings may be blocked.
7. Never use while sleeping or feeling drowsy.
8. Never drop or insert any object into any opening or hose.

9. Do not use in outdoors or operate where aerosol (spray) products are being used or where oxygen is being administered in a closed environment such as an oxygen reservoir.

NOTE, CAUTION, WARNING STATEMENTS AND SYMBOLS:

NOTE : Indicates information that user should pay special attention to.

CAUTION : Indicates correct operating or maintenance procedures in order to prevent damage to or destruction of the equipment or other property.

WARNING : Calls attention to a potential danger that requires correct procedures or practices in order to prevent personal injury.

SYMBOLS :

- O Off, disconnection from the mains
- I On, connection to the mains
- ~ Alternating current

IPX0 Enclosed equipment without protection against ingress of water

Attention

Class II

"BF" symbol, indicate this product is according to the degree of protecting against electric shock for the type BF equipment.

Disposal of Electrical & Electronic Equipment (WEEE): This product should be handed over to an applicable collection point for the recycling of electrical and electronic equipment. For more detailed information about the recycling of this product, please contact your local city office, household waste disposal service or the retail store where you purchased this product.

2. Introduction

2.1 Intended Use

The Pacifica Compressor Nebulizer System is intended to provide a source of compressed air for aerosol therapy. It is used in conjunction with a jet (pneumatic) nebulizer to produce medicated aerosols for inhalation by pediatric and adult patients with respiratory symptoms.

CAUTION - Indications for therapy include **asthma, chronic bronchitis, infection of the upper respiratory tract, chronic obstructive pulmonary disease and other respiratory disorders in accordance with a medical doctor's prescription. Except the usage mentioned above, please do not use this product for any other purpose. This device can be used with adults or pediatric patients under physician's prescription.**

2.2 Safety Precaution Instruction

When using this electrical product, especially when children are present, one should always follow basic safety precautions. Do not install, maintain or operate this equipment without reading, understanding and following the proper Pacifica Compressor System instruction manual, otherwise injury or damage may result. Important information is highlighted by using the following bulletin:

DANGER : Urgent safety information for hazards that will cause serious injury or death.

WARNING : Important safety information for hazards that might cause serious injury or property damage.

CAUTION : Information for preventing damage to the product.

For 120V only-

This appliance has a polarized plug (one blade is wider than the other). To reduce the risk of electric shock, this plug is intended to fit into a polarized outlet only one way. If the plug does not fit fully into the outlet, reverse the plug. If it still does not fit, contact a qualified electrician. Do not modify the plug in any way.

3. Product Description

1. Power Switch
2. Filter Cap (disposable filter inside)
3. Air-Outlet Connector
4. Integrated Carrying Handle
5. Power Cord
6. Nebulizer Holder
7. Cooling Air Openings
8. Disposable Nebulizer Kit

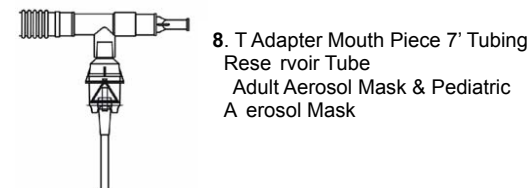
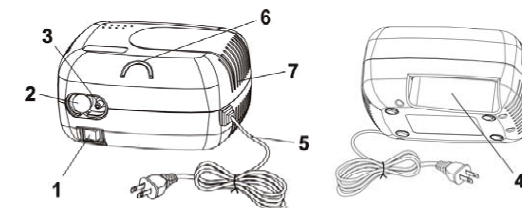

4. Operation

NOTE - Before initial operation, the nebulizer cup assembly should be cleaned following instructions described in the "Cleaning" section.

WARNING - Before connecting the power cord, make sure the I/O (ON/OFF) switch is in the O (OFF) position.

 The plug is also served to disconnect the device.

 L'appareil est également muni d'une fiche de connexion à l'électricité.

4.1 Daily Use Operation

CAUTION - The Pacifica Compressor is designed for intermittent use only. Do not operate it continuously for more than 30 minutes for a single use without turning it off and following a cooling period for least 30 minutes.

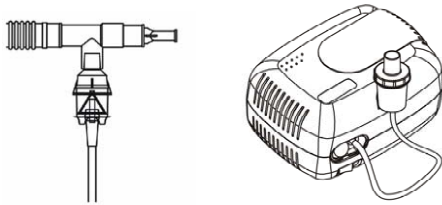

1. Before each use inspect the Pacifica Compressor and nebulizer cup assembly for damage or wear, replace as needed.
2. Place the Pacifica Compressor on a table or other flat stable surface. Be sure you can easily reach the controls when seated. Do not use this device on the floor.
3. With the power switch in the O (OFF) position, plug the power cord into an appropriate electrical wall outlet.
4. Connect one end of the tubing to the compressor air-outlet connector.
5. Assemble the nebulizer cup and add indicated medication to the nebulizer's cup before use.
6. Attach the other end of the tubing into the air-inlet connector founded at the bottom of the nebulizer cup.
7. Turn on the Pacifica Compressor by pressing the power switch to the I (ON) position and begin treatment.
8. If treatment needs to be interrupted, simply press power switch to O (OFF) position.
9. When the treatment is complete, turn off the compressor by pressing the power switch to O (OFF) position and unplug the unit from the electrical outlet.

 Equipment not suitable for use in the presence of a flammable anesthetic mixture with air or with oxygen or nitrous oxide. This device has no AP or APG protection.

 NOTE : L'équipement ne peut être utilisé s'il y a risque de mélange d'un anesthésique inflammable avec l'air ou l'oxygène ou oxyde nitreux.

4.2 Safety Overload

NOTE - Do not exceed 30 minutes of continuous operation.

1. The motor of this device has a built-in thermal overload protector. Should the motor overheat, the protector will automatically shut off the motor. Should this occur, turn the I/O (ON/OFF) switch to the O (OFF) position and allow the motor to cool down for approximately 30 minutes before turn it on again.
2. If the overload protector shuts off the motor frequently, you may have an unstable voltage situation.
3. If the unit shuts down and cannot restart, it may need to be replaced. Call your provider immediately.

5. Cleaning

5.1 Compressor Outer Case Cleaning

WARNING - Electric shock hazard. Do not remove outer case of this unit. All disassembly and maintenance of this unit must be done by a qualified service technician. Refer servicing to qualified service personnel.

WARNING - This unit does not require oil. Do not attempt to lubricate any internal parts.

WARNING - Unplug unit before cleaning. Do not submerge in water for cleaning.

1. Wipe the main unit with a damp cloth every few days to keep it dust-free.
2. Do not use any powdered type cleaners or soap. Do not submerge the unit into water.

5.2. Nebulizer Cup Cleaning

All parts of the disposable nebulizer, except tubing, should be thoroughly cleaned after each use. If your doctor specifies a specific cleaning procedure, follow that procedure.

WARNING -To prevent possible risk of infection from contaminated medication, cleaning of the nebulizer is recommended after each treatment.

1. After each use, disassemble the nebulizer cup, tee and mouthpiece completely, wash all parts in warm soapy water and rinse thoroughly. Allow to air dry. Store in a clean dry location.
2. Once daily, after washing as above, soak nebulizer components in a fresh solution consisting of one part warm water and one part white vinegar for 30 minutes followed by a warm water rinse.

NOTE - The disposable nebulizer kit is for single patient use only.

NOTE - Please follow national requirements to dispose the unit properly.

6. Storage

Keep the unit and accessories dry. Avoid direct sunshine.

7. Maintenance

7.1 General Information

1. This unit is oil-less. Do Not Lubricate.
2. Risk of electric shock. Do not disassemble the main unit.
3. All maintenance must be performed by a qualified service personnel.

7.2 Filter Change

NOTE - Change the filter once every month or when filter turns gray. Please follow the below instructions as right figures.

1. Open the filter cap.
2. Remove dirty filter with a small, pointed object. Discard the filter.
3. Replace with a clean filter. Additional filters should be purchased from your provider.
4. Put the filter cap back.

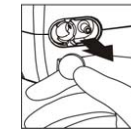
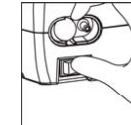

CAUTION - Do not use cotton or any other material as a filter. Do not wash or reuse the filter. Do not operate the unit without a filter.

8. Troubleshooting

If your Pacifica Compressor Nebulizer fails to function, consult the Troubleshooting guide below. If the problem persists, consult your equipment provider.

Problem	Cause and Solution
Device doesn't operate.	<ul style="list-style-type: none"> ·Check if plug is properly fit into an appropriate electrical outlet. ·When device has been run continuously for over 30 minutes right before using, an auto shut down may activate by built-in thermal protector, cool down device for 30 minutes before next usage.
Weak Nebulization	<ul style="list-style-type: none"> ·Check for proper electrical voltage. ·Check tubing for blockage or air leakage at connection to Pacifica compressor or nebulizer cup, replace as needed. ·Check the nebulizer cup if it is properly assembled and not damaged. If there is any damage, replace as needed. ·Check if filter is too dirty, replace as needed.

9. Specifications

Electrical Rating (Note: Refer to the rating label on the product)	<ul style="list-style-type: none"> • 100VAC,60Hz, 1.2A • 120VAC,60Hz, 1.2A • 230VAC,60Hz, 0.6A 	<ul style="list-style-type: none"> • 100VAC,50Hz, 1.2A • 230VAC,50Hz, 0.6A • 230V-240VAC, 50Hz, 0.6A
Maximum Compressor Pressure	≥30 psi	≥30 psi
Operating Flow Rate	≥5.5 lpm	≥5.0 lpm
Nebulization Rate	0.2 - 0.3 ml/min	
Particle size	0.5 ~ 5 microns*	
Classification	Class II. BF equipment. IPX0 No AP/APG protection.	
Applied part	Mouthpiece or Nasal mask	
Dimensions (W x D x H)	14.0 × 18.8 × 10.0 cm / 5.5" × 7.4" × 3.9"	
Weight	1.8 kg / 4.0 lb	
Fuse (see note 3)	T5A 250VAC for 120V system, T1.6A 250VAC for 230V system	
Environment	Temperature	Operation: 10°C to 40°C/ 50°F to 104°F
		Storage: -15°C to 50°C / 5°F to 122°F
	Transport: -15°C to 70°C/ 5°F to 158°F	
Humidity	Operation: 10% to 90%RH non-condensing	
	Storage: 10% to 90%RH non-condensing	
	Transport: 10% to 90% RH non-condensing	

Note:

1. * Values are determined by supplier's nebulizer.
2. Consult distributor(s) for additional technical documents.
3. The Nebulizer is fitted with a fuse as specified in the Specification column, it is designed to be maintained by the manufacturer or its agents. Users are not allowed to open the cover to replace a blown fuse.

MANUFACTURED FOR:

Drive Medical Design & Manufacturing
99 Seaview Boulevard
Port Washington, NY 11050